

1 | 1 | 2 | 1 | 3 | 1 | 4 | 1 | 5 | 1 | 6 | 1 | 7 | 1 | 8

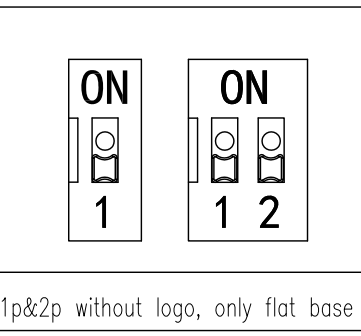

DIM A/B	Long Pin	Short Pin
Convex base	3.65	2.85
Flat base	3.80	3.00

REV	ECN	CONTENT	CHECK	DATE
V0.0		ORIGINAL	YZG	2016.09.15
V1.0		arrange the drawing	LJ	2019.09.21
V2.0		arrange the drawing	WL	2020.06.03

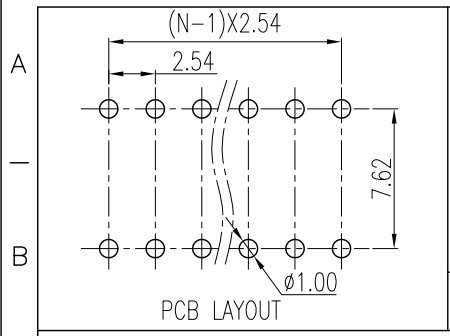
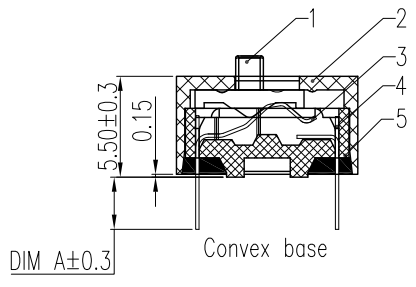
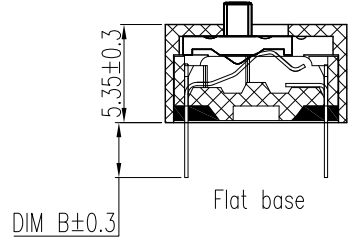
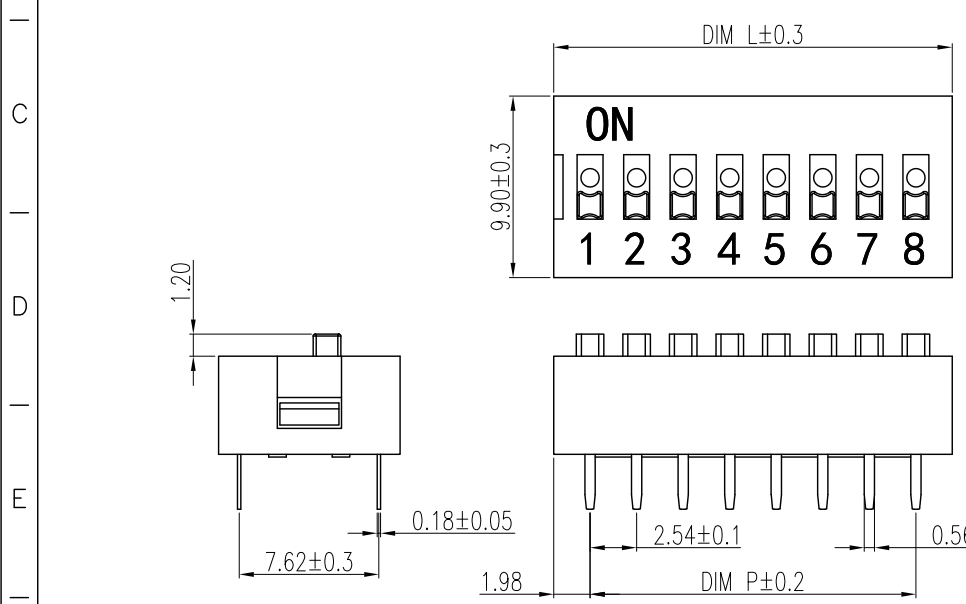

SPECIFICATION:

- Rating:
 - Switching: 25mA, 24VDC
 - Non-Switching: 100mA, 50VDC
- Contact Resistance:
 - Initial: 50mΩ max
 - After Life Test: 100mΩ max
- Insulation Resistance: 100MΩ min/500 VDC
- Withstand Voltage: 500VAC for 1 minute
- Operation Force: 1000g max
- Travel: 2.0mm
- Mechanical Life: min 2000 cycles
- Operation Temperature: -40°C ~ +85°C
- Storage Temperature: -40°C ~ +85°C

SOLDERING INFORMATION:

Manual Soldering: 30W iron, 320±5°C, 3S max
 Wave Soldering: 250±10°C, 5S max

Keep in "off" position during soldering



POLES	DIM P	DIM L
1	/	3.96
2	2.54	6.50
3	5.08	9.04
4	7.62	11.58
5	10.16	14.12
6	12.70	16.66
7	15.24	19.20
8	17.78	21.74
9	20.32	24.28
10	22.86	26.82
11	25.40	29.36
12	27.94	31.90

5	Base	XX	1	Thermoplastic	UL94V-0
4	Pin2	XX	P	Coppo Alloy	Gold Plated
3	Pin1	XX	P	Coppo Alloy	Gold Plated
2	Housing	XX	1	Thermoplastic	UL94V-0
1	Actuator	XX	P	Thermoplastic	UL94V-0
ITEM	NAME OF PART	NO. OF PART	Q'TY	MATERIAL	NOTE
APP.	LJ	DATE	2020.6.3	NAME	DS Slide Series Dip Switch
CHK.	LJ	DATE	2020.6.3		
DWG.	WL	DATE	2020.6.3	DWGNO.	W20004282
UNITS	MM	SCALE	1:1	SHEET	1/1
				PROJECTION-METHOD	

General tolerance in mm						radii and chamfers			shorter angle side			=	— //		
over 0 to 3	over 3 to 6	over 6 to 30	over 30 to 120	over 120 to 400	over 400 to 1000	over 0.5 to 3	over 3 to 6	over 6	up to 10	over 10 to 50	over 50 to 120	all	over 0 to 100	over 100 to 150	over 150
±0.15	±0.2	±0.25	±0.3	±0.5	±0.8	±0.2	±0.5	±1.0	±1°	±30'	±20'	0.5	0.2	0.3	0.5

乐清市戴尔电子有限公司
YUEQING DAIER ELECTRON CO., LTD

1 | 1 | 2 | 1 | 3 | 1 | 4 | 1 | 5 | 1 | 6 | 1 | 7 | 1 | 8